

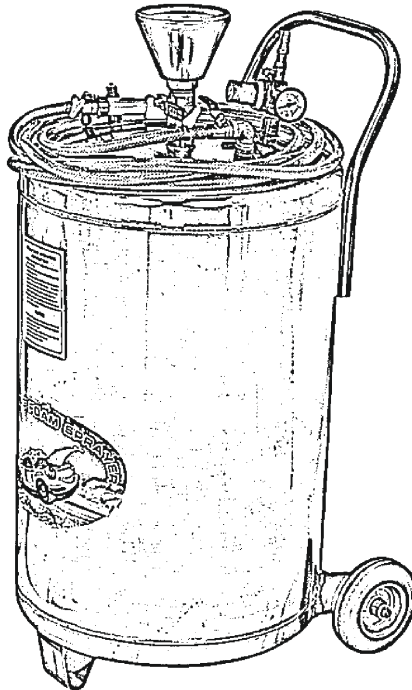

FOAM SPRAYER

Original Operating Instructions

ID FS80
Part No.:29019



Read though carefully and understand these instructions before use.

FOAM TANK OPERATION IN STRUCTION

- A:** Please open the (15) value to facilitate the air discharge.
- B:** Add water from (9) until the (17) is full of water level.
- C:** Add the cleaner in to the FOAM tank, the general ratio of 80L (water) of 1000cc cleaner. Due to the different character is tics of each brand cleaner, and according to the actual need so foam effect, the cleaner proportional can be in creased or decreased.
- D:** The (15) will be shut down open the (11) to complete the adding process, then you can use the foam machine.

NOTICE

1. The machine has been set inlet pressure 0.3bar, except the absence of peculiar circumstance, we need n't adjust the Pressure-regulating valve.
2. If air pressure is from 0.2bar, we can make the foam to be produced in the best state.

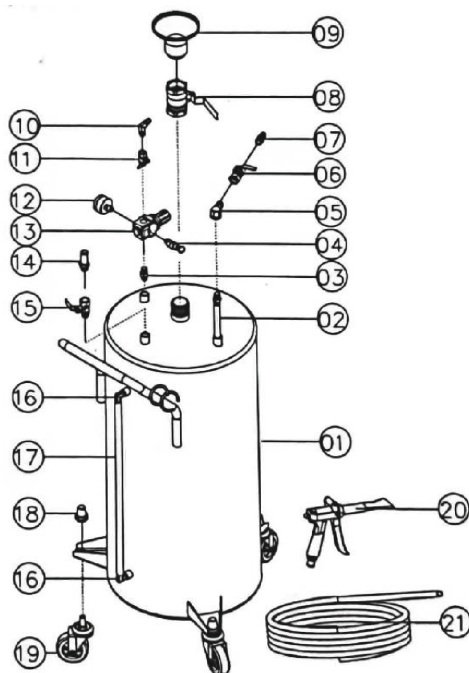

S/N	PARTS NAME	PCS
①	Foam Tank	1
②	Stainless Steel Tube	1
③	3/8M x1/4M Male Joint	1
④	Safety Valve	1
⑤	3/8F/M Bend Joint	1
⑥	3/8F/F Switch	1
⑦	3/8M x 13.5 Joint	1
⑧	1-1/4 Switch	1
⑨	Plastic Funnel	1
⑩	1/4 Bend Joint	1
⑪	1/4F/M Switch	1
⑫	Pressure Gauge	1
⑬	Pressure-regulating valve	1
⑭	PT3/8 Plastic Joint	1
⑮	3/8F/M Switch	1
⑯	Indicator Joint	2
⑰	Indicator Tube	1
⑱	Plastic Cover	3
⑲	Wheel	3
⑳	Foam Gun	1
㉑	Foam Tube	1

Notes

